



GSK PURNIMA RESIDENCY

GSK REAL ESTATE PROPERTIES & DEVELOPERS



ABOUT US

GSK Real Estate Properties & Developers is well known real estate firm, having its office at, A.T. Road, Gate No 4, Maligaon, Guwahati - 781011, Kamrup (M) Assam. The current ongoing project site at Garal, Airport Road, Dharapur, Guwahati - 17. The firm takes pride in delivering their valued customers not only projects, but also happiness and satisfaction.





SPECIFICATIONS

Building	Two blocks of G+6 (Block-A)& G+8 (Block-B) consisting of Deluxe and Super Deluxe flats of 1, 2 & 3 BHK.
Structure	Earthquake resistant RCC framed structure.
Flooring	All Rooms, Drawing, Dining, Balconies, Kitchen will have vitrified tiles.
Kitchen	Granite/marble slab, stainless steel sink, ceramic wall tiles above slab upto 2.5 feet.
Toilets	Superior quality of CP fittings and tiles on wall upto door level and anti-skid floor tiles.
Doors	Main door decorative panelled door. All other doors will be flush door with quality hardware.
Windows	Anodized aluminium sliding windows.
Water	24 Hours water supply with iron removal plant.
Wall	Water-proof weather coat paints. Wall putty with one coat primer on interior wall.
Fire Safety	Fire fighting devices in each floor & fire water reservoir.
Lift	One lift in Block A & two lifts in Block B with decorated lift fascia.
Generator	For lifts, pumps & common areas.
Electrical	Multistrand copper wiring. One AC point at master bedroom & TV point at drawing room and master bedroom, one washing machine point at one balcony.
Staircase & Lobby	Finished with marble & tiles.



BLOCK A

TYPICAL FLOOR PLAN (1ST-5TH FLOOR)

Area of flat D

C.A. - 836.80 sqft.

B.A. - 85.32 sqft.

C.B.A. - 16.78 sqft.

E.W.A. - 95.78 sqft.

B.U.A. - 1034.68 sqft.

S.B.U.A.- 1293.35 sqft.

Area of flat C

C.A. - 617.19 sqft.

B.A. - 31.74 sqft.

C.B.A. - 14.84 sqft.

E.W.A. - 67.26 sqft.

B.U.A. - 731.03 sqft.

S.B.U.A.- 914.00 sqft.

Area of flat B

C.A. - 617.19 sqft.

B.A. - 31.74 sqft.

C.B.A. - 14.84 sqft.

E.W.A. - 67.28 sqft.

B.U.A. - 731.03 sqft.

S.B.U.A.- 914.00 sqft.

Area of flat A

C.A. - 834.00 sqft.

B.A. - 84.25 sqft.

C.B.A. - 28.08 sqft.

E.W.A. - 85.98 sqft.

B.U.A. - 1032.31 sqft.

S.B.U.A.- 1291.00 sqft.



Area of flat E

C.A. - 901.26 sqft.

B.A. - 75.00 sqft.

C.B.A. - 26.15 sqft.

E.W.A. - 95.54 sqft.

B.U.A. - 1097.95 sqft.

S.B.U.A.- 1372.00 sqft.

Area of flat F

C.A. - 614.29 sqft.

B.A. - 31.53 sqft.

C.B.A. - 19.80 sqft.

E.W.A. - 51.33 sqft.

B.U.A. - 742.40 sqft.

S.B.U.A.- 928.00 sqft.

Area of flat G

C.A. - 605.57 sqft.

B.A. - 34.21 sqft.

C.B.A. - 18.72 sqft.

E.W.A. - 81.14 sqft.

B.U.A. - 739.64 sqft.

S.B.U.A.- 925.00 sqft.

Area of flat H

C.A. - 709.41 sqft.

B.A. - 66.59 sqft.

C.B.A. - 27.22 sqft.

E.W.A. - 86.31 sqft.

B.U.A. - 889.53 sqft.

S.B.U.A.- 1112.00 sqft.

BLOCK B

TYPICAL FLOOR PLAN (1ST-8TH FLOOR)

Area of flat I

C.A. - 854.55 sqft.

B.A. - 83.28 sqft.

C.B.A. - 26.79 sqft.

E.W.A. - 88.35 sqft.

B.U.A. - 1052.97 sqft.

S.B.U.A.- 1316.00 sqft.

Area of flat J

C.A. - 594.38 sqft.

B.A. - 23.99 sqft.

C.B.A. - 17.86 sqft.

E.W.A. - 71.67 sqft.

B.U.A. - 707.90 sqft.

S.B.U.A.- 885.00 sqft.

Area of flat K

C.A. - 595.14 sqft.

B.A. - 23.99 sqft.

C.B.A. - 17.86 sqft.

E.W.A. - 72.01 sqft.

B.U.A. - 708.00 sqft.

S.B.U.A.- 885.00 sqft.

Area of flat L

C.A. - 406.01 sqft.

B.A. - 32.28 sqft.

C.B.A. - NA

E.W.A. - 37.67 sqft.

B.U.A. - 476.51 sqft.

S.B.U.A.- 595.56 sqft.

Area of flat M

C.A. - 755.03 sqft.

B.A. - 63.59 sqft.

C.B.A. - 27.00 sqft.

E.W.A. - 88.38 sqft.

B.U.A. - 934.00 sqft.

S.B.U.A.- 1168.00 sqft.

BLOCK B
TYPICAL FLOOR PLAN
(1ST-8TH FLOOR)



BUILDING

FULL VIEW





SAMPLE 3BHK



SAMPLE 2BHK



SAMPLE 1BHK



AMENITIES

Children Park



Prayer Premises



Garden Area



Gym



Badminton Court



Security Room



Conference Hall

LOCATION MAP

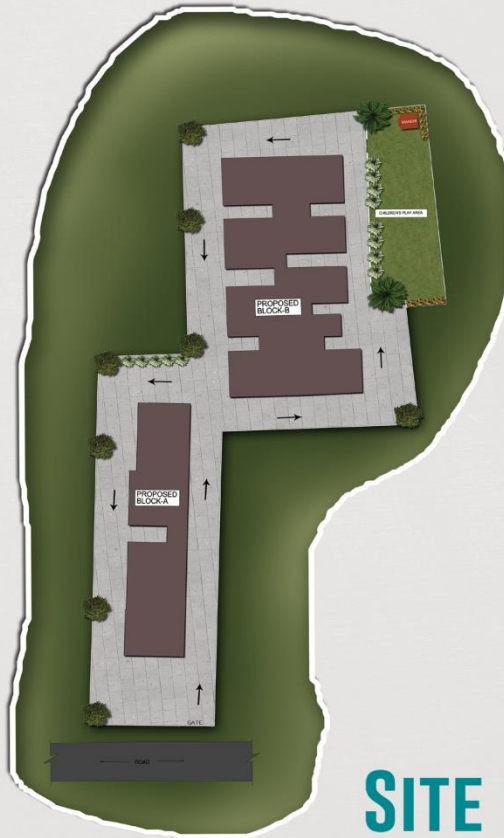
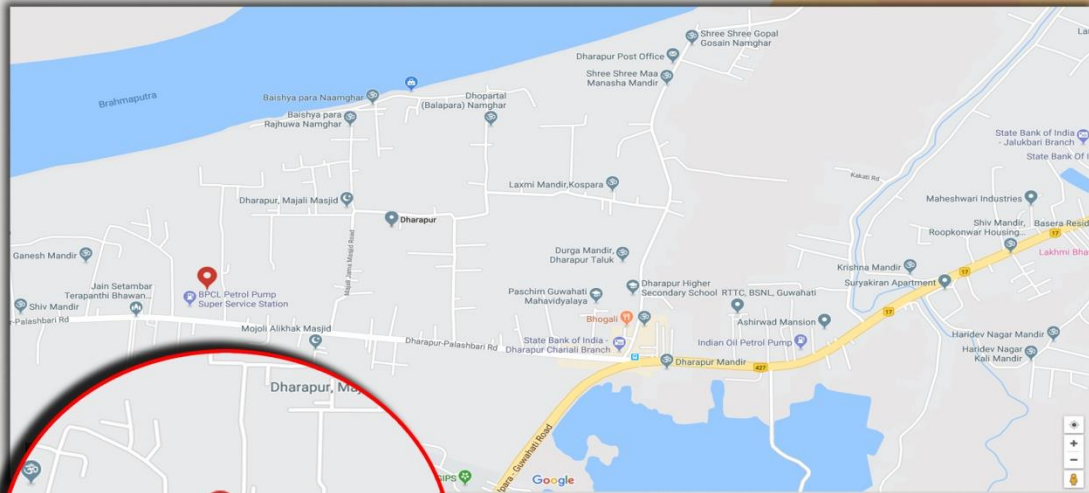

SITE PLAN

SITE ADDRESS

New Airport Road, Garol, Dharapur,
Adjacent Bharat Petroleum, Guwahati
781017 Kamrup (M)

DEVELOPER

GSK Real Estate Properties & Developers
AT Road, Gate no 4, Maligaon,
Guwahati-781011
Kamrup (M), Assam
70027 88322 / 98640 21017 / 98640 21244 / 7670013555
94350 44790
gskdevelopers@rediffmail.com

ARCHITECT

Amitabh Sarma
Akar Foundation, BK Kakoti Road,
Ulubari, Guwahati-781007
Kamrup (M), Assam